

MAIN FIGURE	
CO-ORDINATES SYSTEM WG 19	
CONSTANTS +0,00 +3700000,00	
Y METRES X	
A	+ 12 859,72 + 60 389,84
B	+ 12 758,21 + 60 304,47
C	+ 12 690,27 + 60 376,11
D	+ 12 790,72 + 60 471,51
REFERENCE MARKS	
REF1	+ 12 686,42 + 60 382,97
REF2	+ 12 776,11 + 60 463,05

TRIGONOMETRICAL BEACONS				
394	LIBERTAS	△	+ 14 120,50	+ 58 672,23
404	PARADYS	△	+ 10 183,10	+ 59 563,40

AREAS	
ERF NO.	SQUARE METRES
17721	1166
17722	1128
17723	1033
17724	1096
17725	999
17726	998
17727	999
17728	1094
17729	1030
17730	1133
17731	1176
17732	1831

CDR

(STELLENBOSCH ALLOTMENT AREA)

GENERAL PLAN NO. 662/2022

of
Subdivision of Erf 17720 Stellenbosch

vide S.G. Diagram No. 8448/1948 annexed to D/T No. 1950-2621
and comprising 12 erven numbered 17721 - 17732

Situate in the Stellenbosch Municipality
Administrative District of Stellenbosch
Province of Western Cape

SCALE 1:300

Servitude notes:
1. The line AB represent the North western boundary of a services servitude 5,00 metres wide, as shown.
2. The line ef represents the South western boundary of a services servitude 3,00 metres wide, as shown.

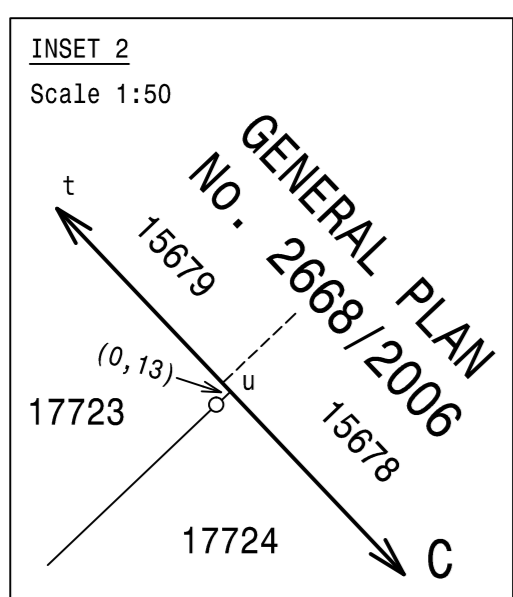
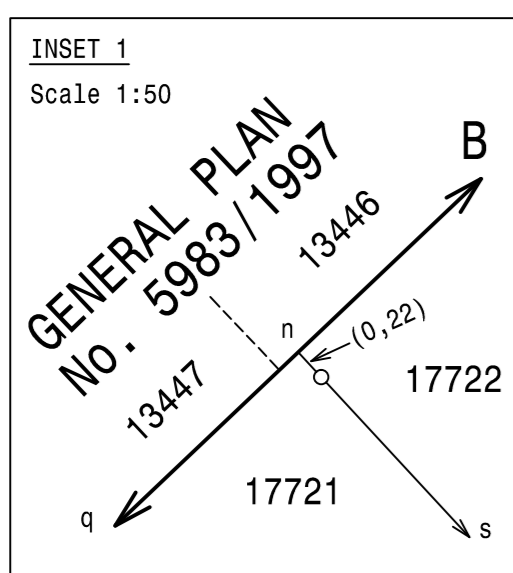
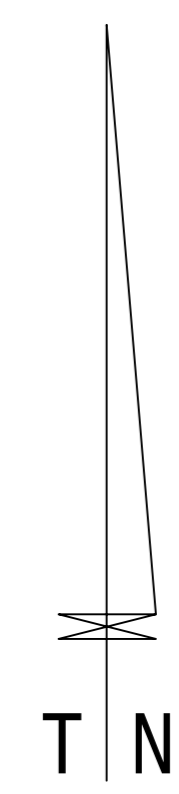

Beacon Descriptions	
A	Corner of wall
B	Fencing post
C	12mm Drill hole in concrete
D	Not beacons
All other beacons	12mm Iron peg
Reference Marks	
REF1 REF2	16mm Iron peg

Surveyed by me in accordance with the Land Survey Act No. 8/1997
M. R. Stuart-Fox
M.R. STUART-FOX (PLS 1354)
Professional Land Surveyor
Date : October 2021 and February 2022

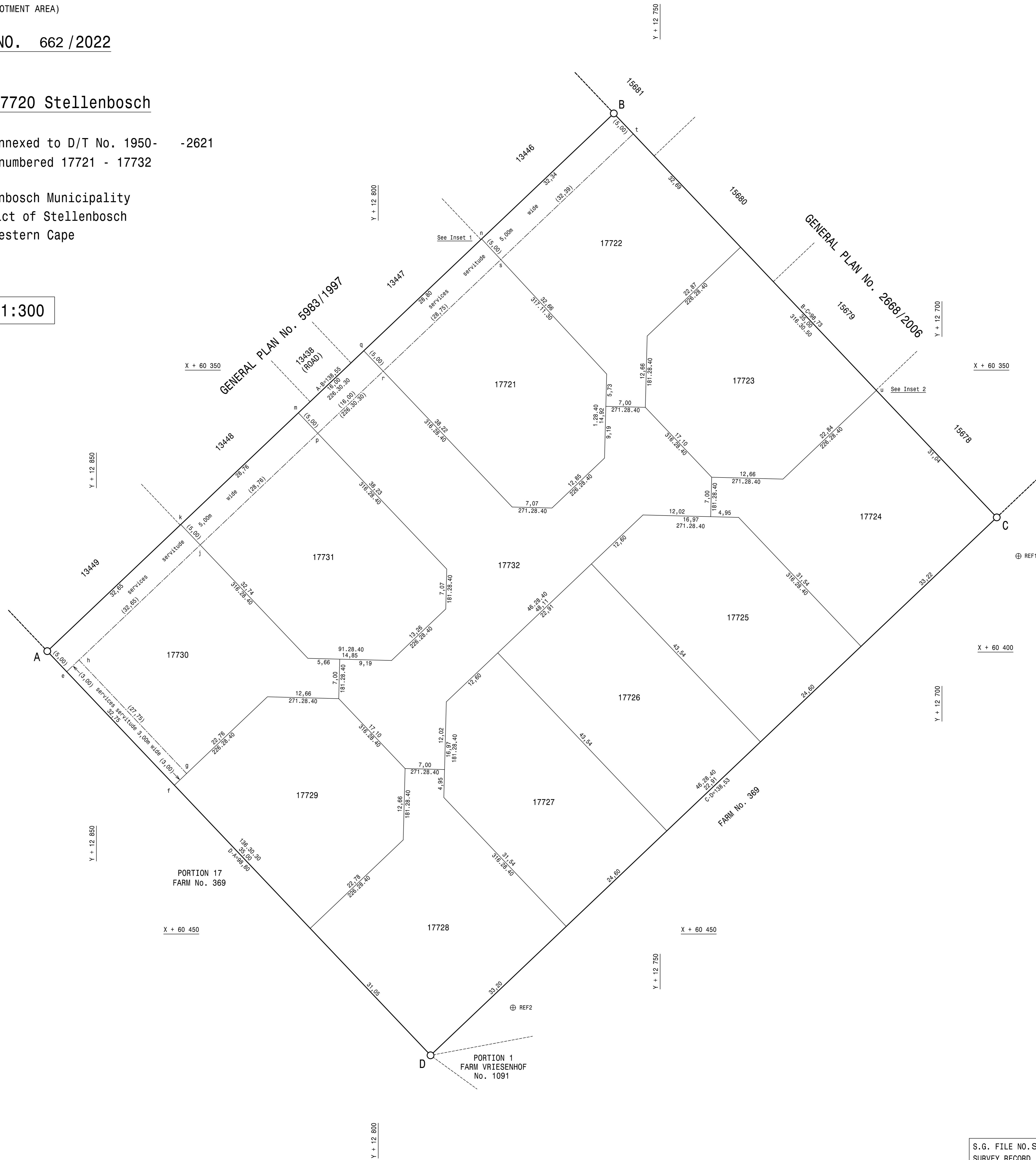

SG NO. 662/2022
Approved : *[Signature]*
for Surveyor General
Date : 17/05/2022
APPROVED IN TERMS OF SECTION 60 OF THE STELLENBOSCH MUNICIPAL LAND USE PLANNING BY-LAW (2015)
REF. : LU/10807
DATE : 2021-04-16 2021-05-18

Act 70/70
NOT APPLICABLE

ENDORSEMENTS					
NO.	AMENDMENT	ADDITION	AUTHORITY	INTD	DATE

S G OFFICE NOTES

S.G. FILE NO. Stei.373 V3
SURVEY RECORD : 440/2022
COMPILATION : BH-8DCD (3785)
LPI C0670022